

WIJZE VAN PLAATSEN

Type 1 Schaal 1/20

Rechte oever, niet verharde berm

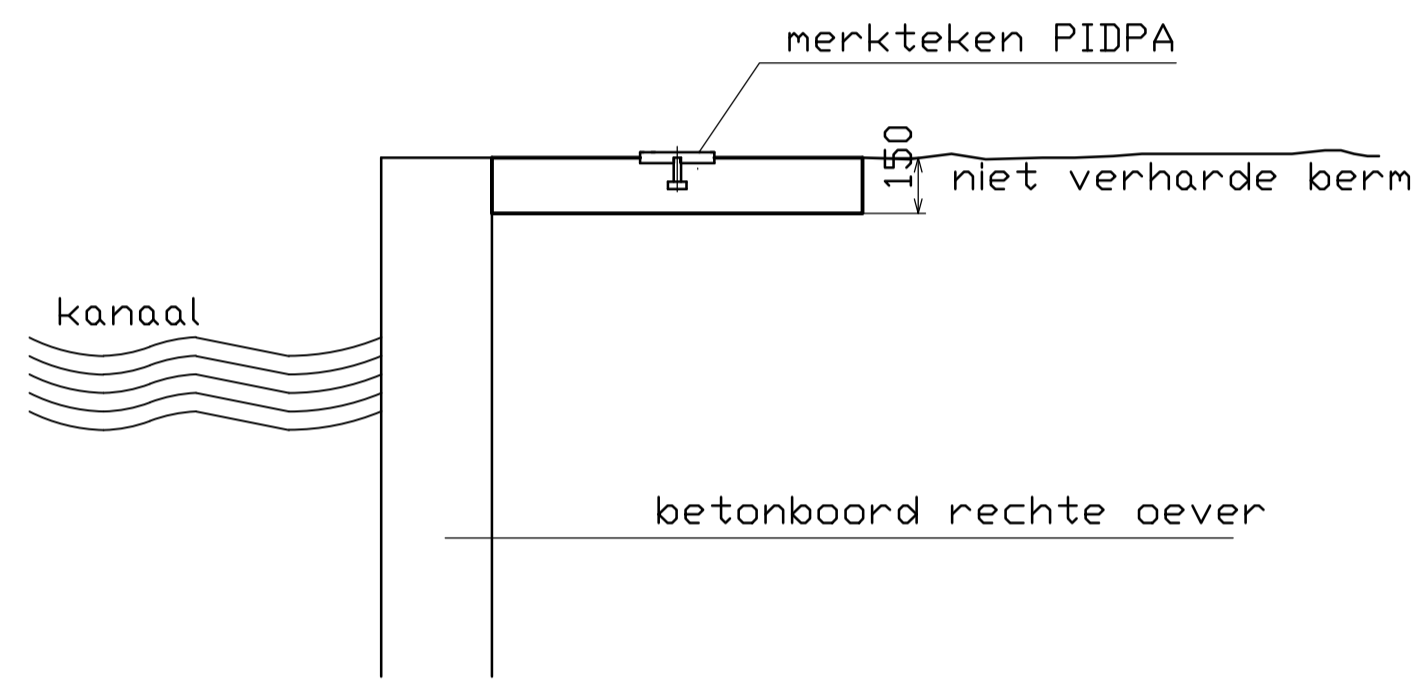
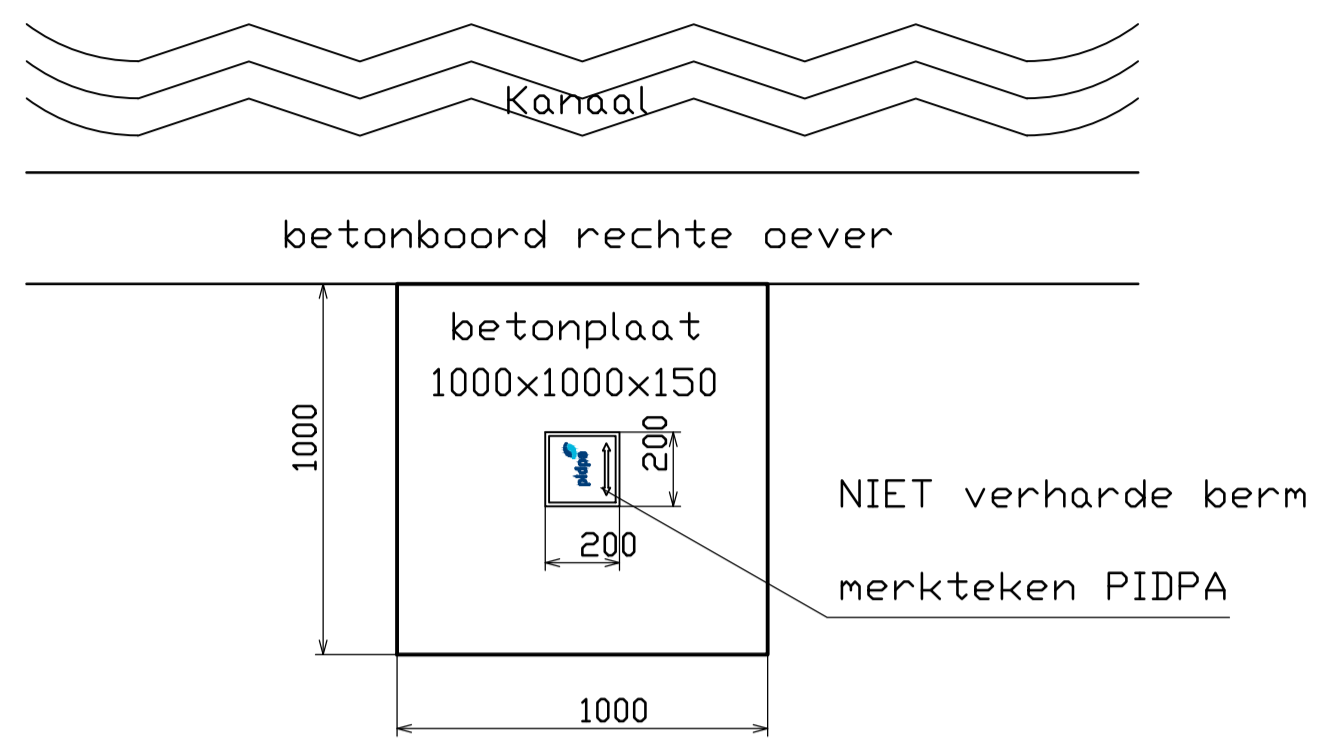

Type 3 Schaal 1/20

Schuine oever, niet verharde berm

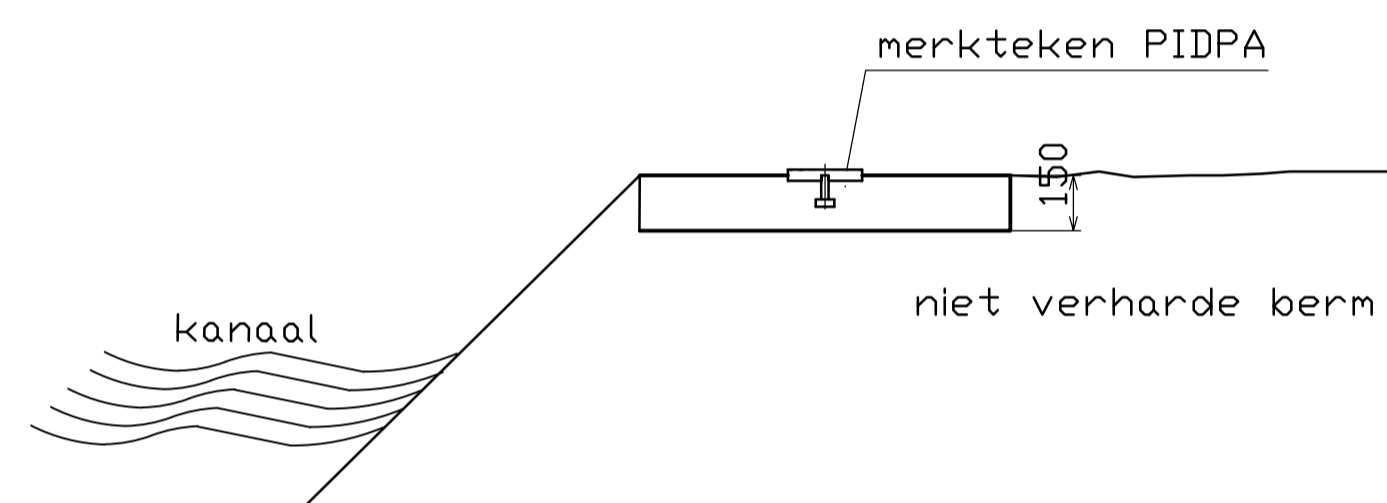
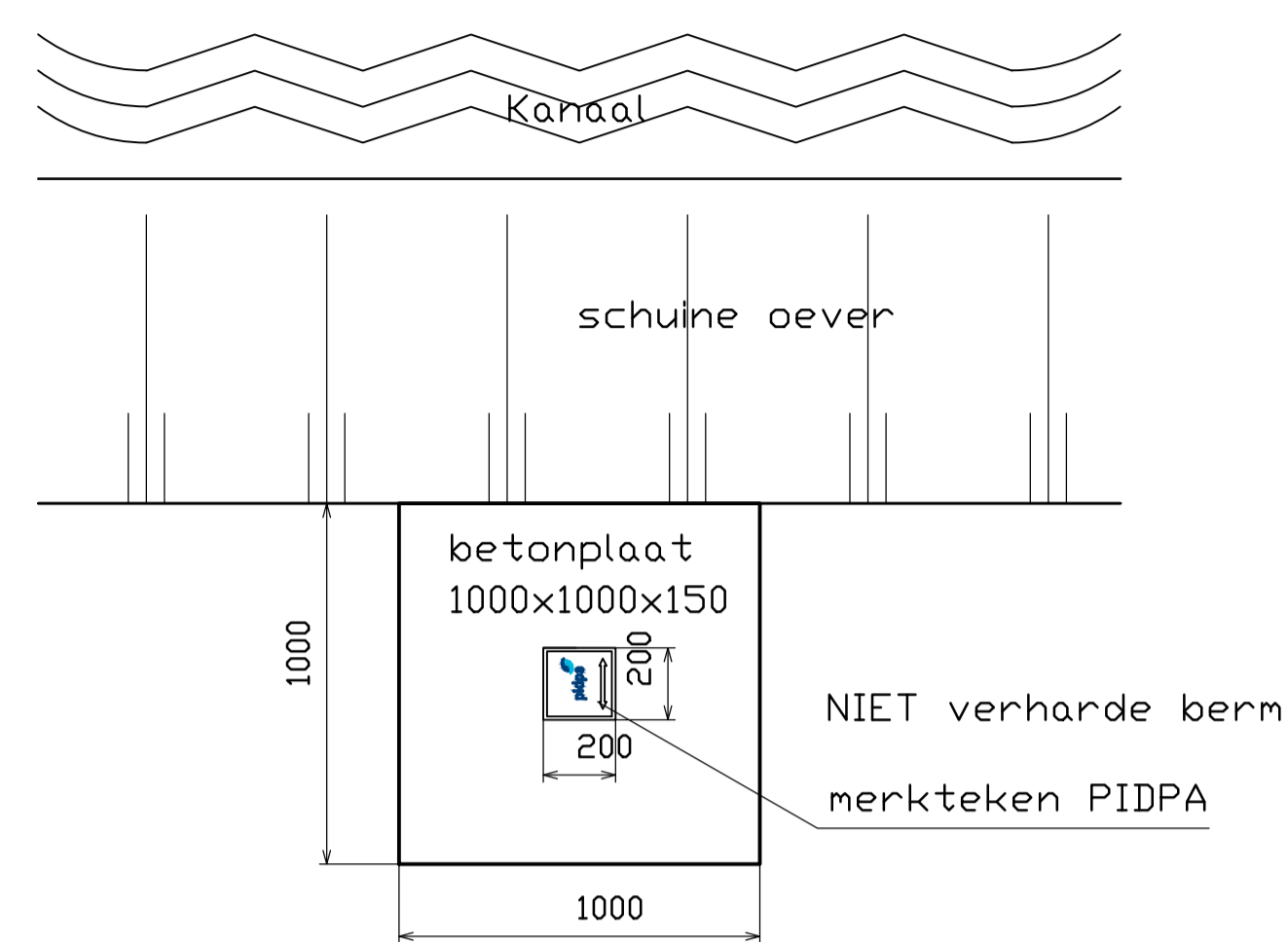

Type 2 Schaal 1/20

Rechte oever, verharde berm

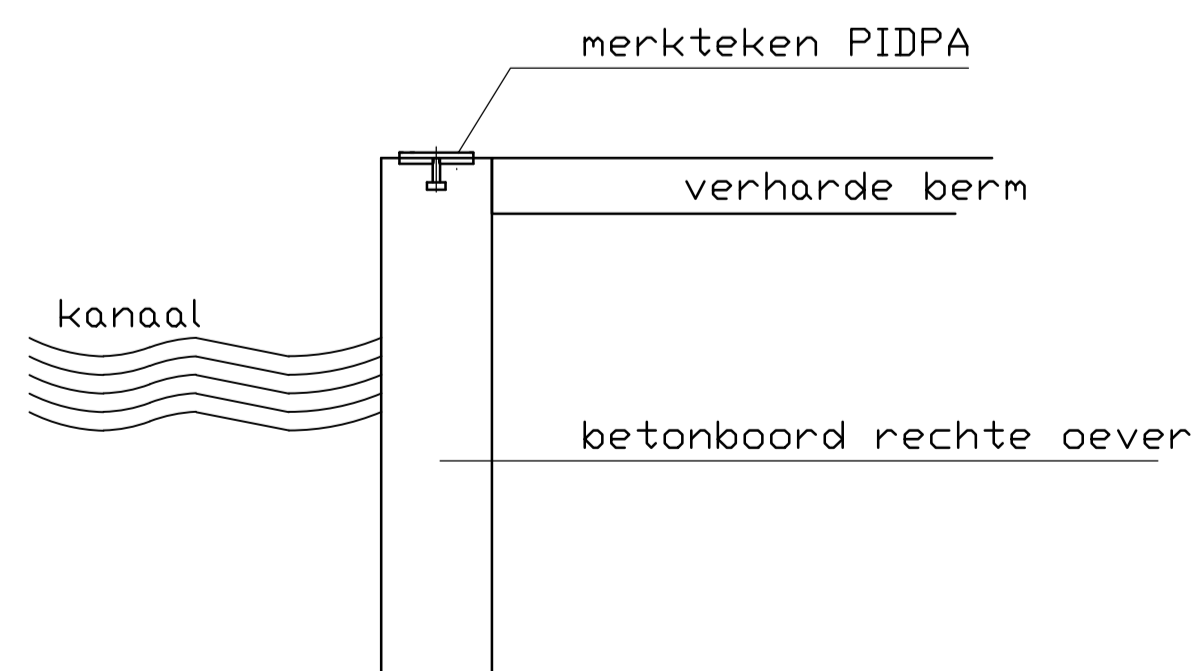
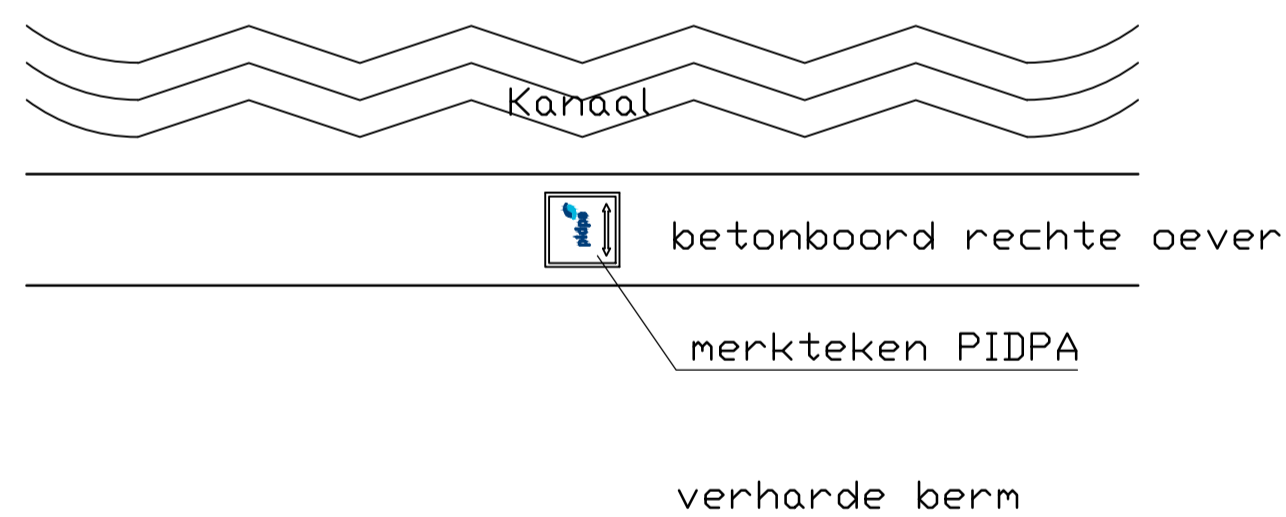

Type 4 Schaal 1/20

Schuine oever, verharde berm

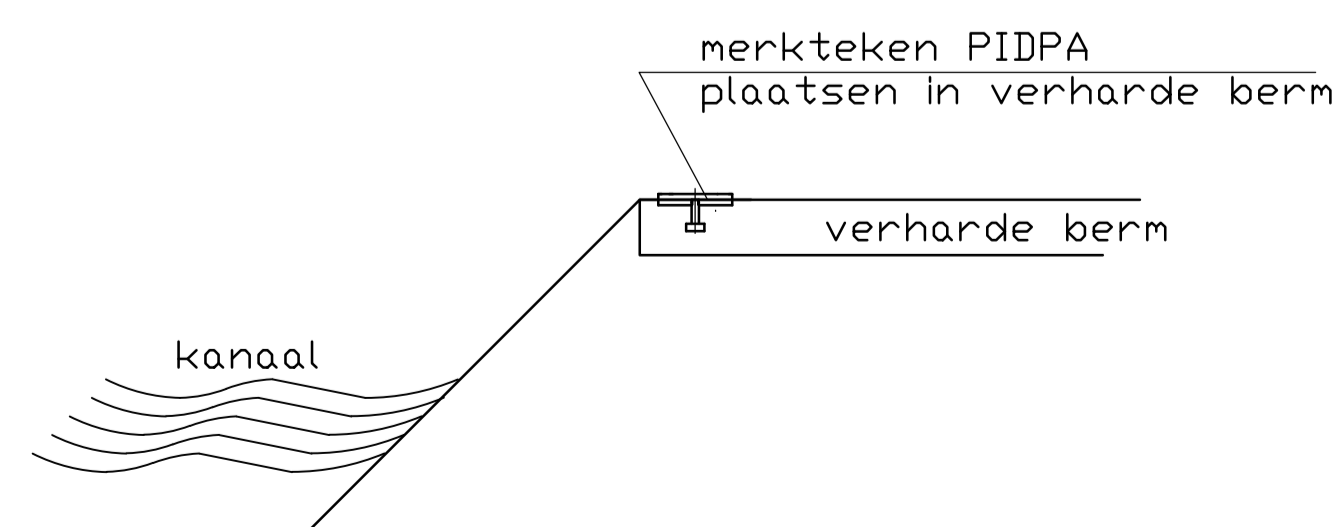
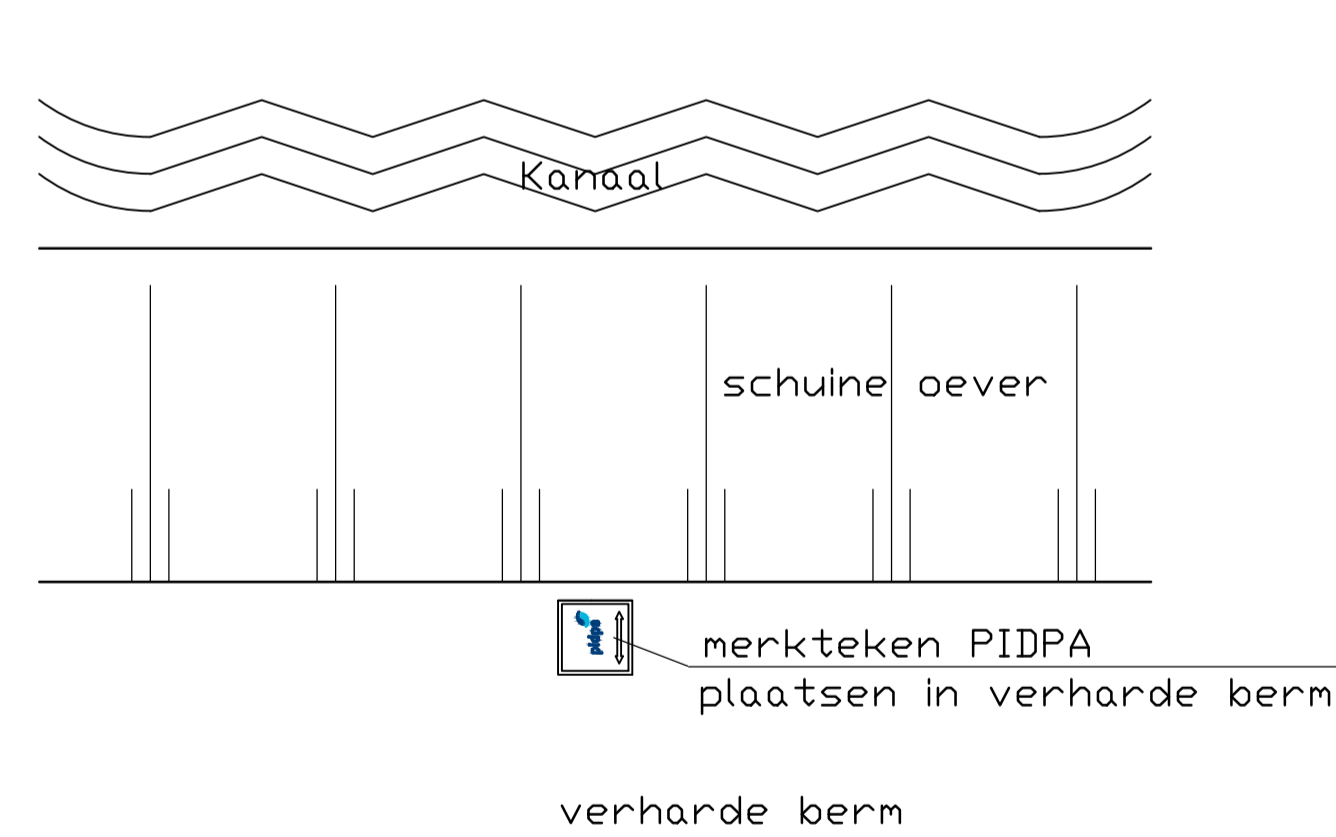

RICHTINGSSTEEN Bovenzicht

Schaal 1/1

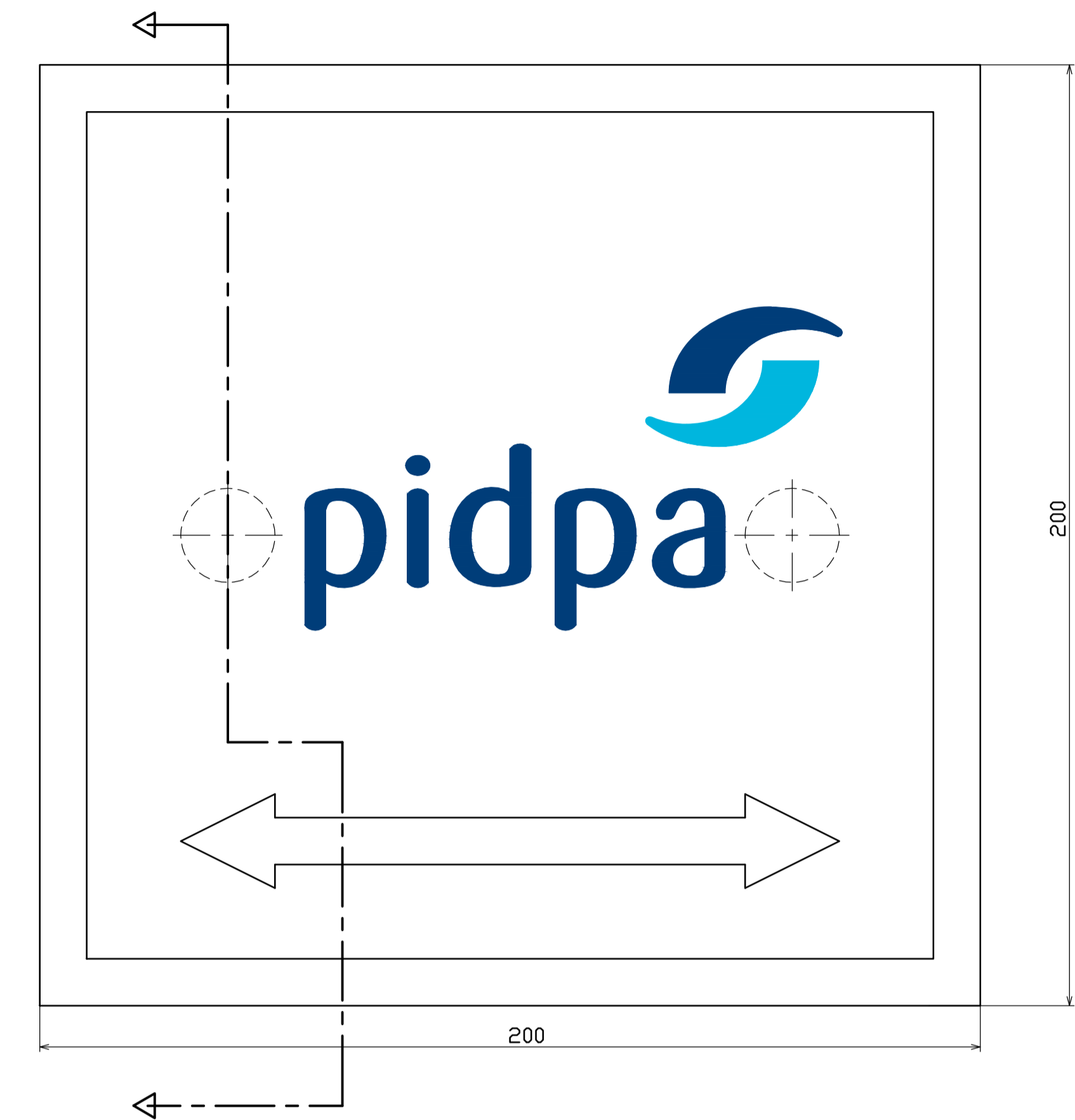

Doorsnede

Schaal 1/1

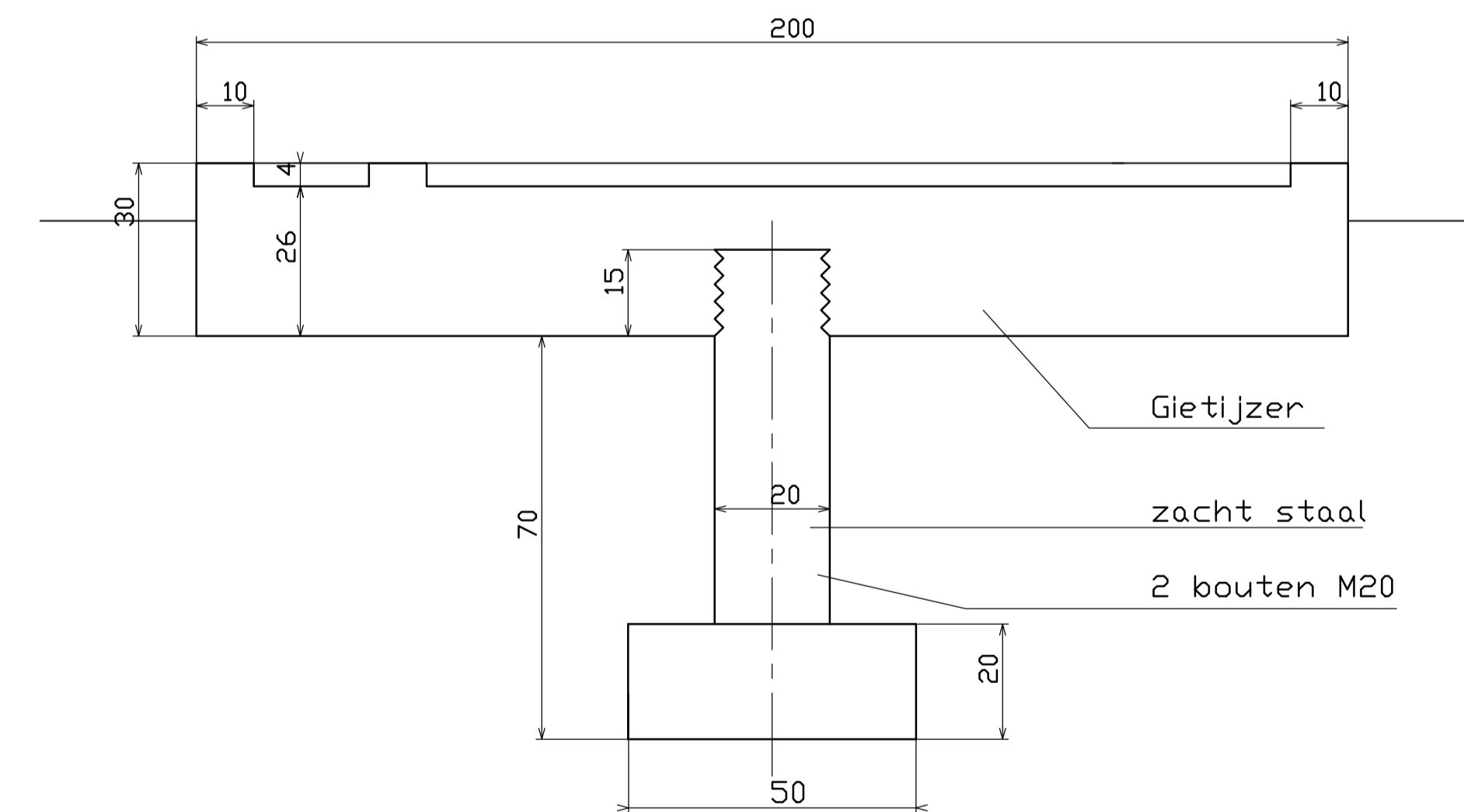

maten in mm

richtingssteen minimum 2/3 inwerken in betonplaat of bestaande verharding

B	Aanpassing nieuw logo	EPV	29-09-15
A	Aanpassing nieuwe huisstijl	EPV	13-05-28
WIJZIGING		DATUM	
Richtingssteen PIDPA en wijze van plaatsing		DATUM	09/03/99
SCHAAL		versch.	
GETEKEND			
BLAD:	AANTAL:		
PLAN NR:	C 190		
WIJZIGING			



VIERSELSEBAAN 5 2280 GROBBENDONK
Tel: 0800 90 300 - Fax : 03 260 60 03
e-mail: info@pidpa.be